

A project by
GOLD BRICKS
INFRASTRUCTURE PVT. LTD.

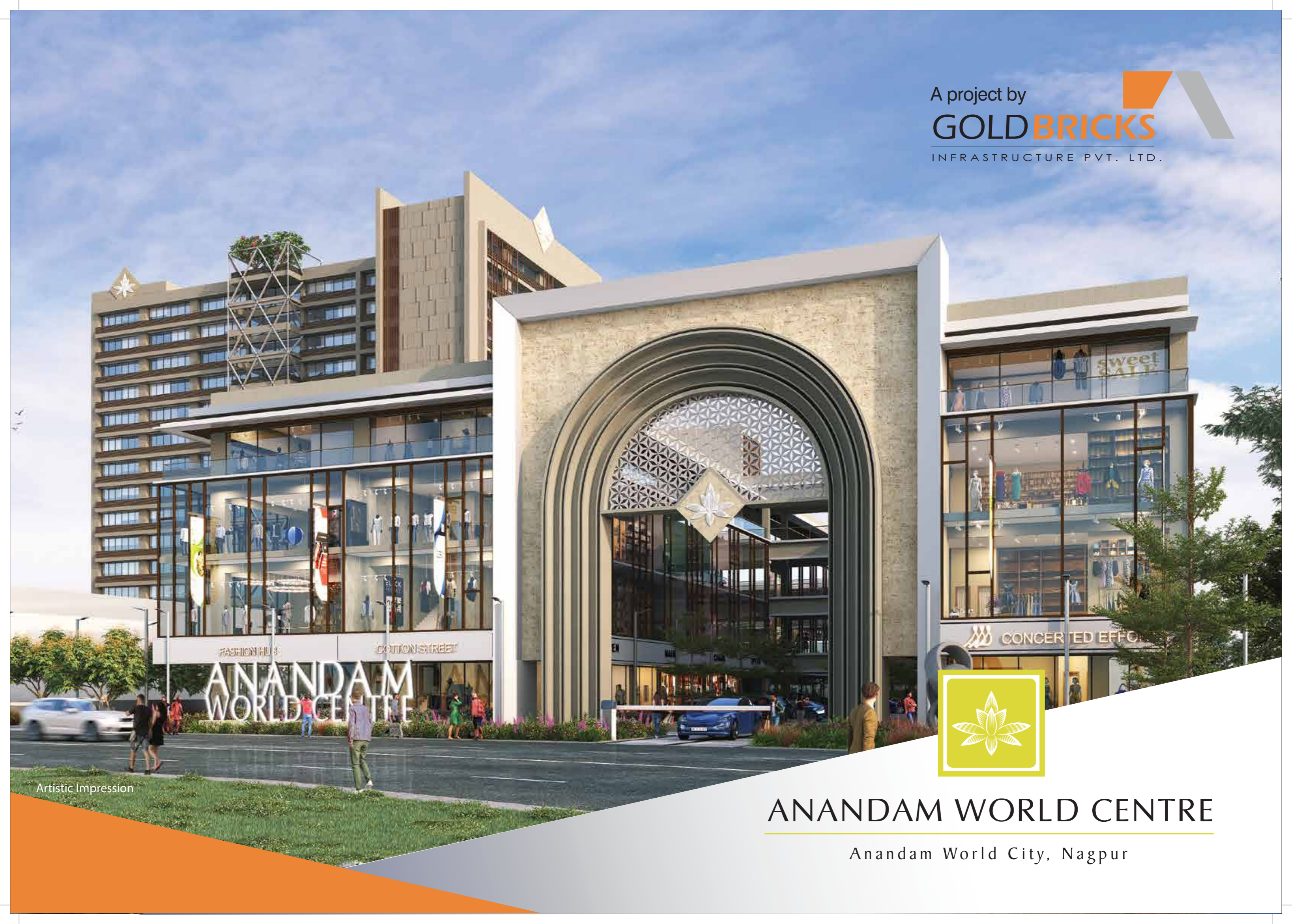

Artistic Impression



ANANDAM WORLD CENTRE

Anandam World City, Nagpur



A WORLD
YOU DESERVE

Artistic Impression



ANANDAM WORLD CENTRE
Anandam World City, Nagpur

● Imp Landmark

A LOCATION ENCIRCLED BY
OPPORTUNITIES



ANANDAM

SHOPPING CENTRE

Anandam World Centre, Nagpur





Artistic Impression

A WORLD WHERE
RETAIL OUTSHINES



Artistic Impression

TYPICAL 1ST AND 2ND FLOOR PLAN

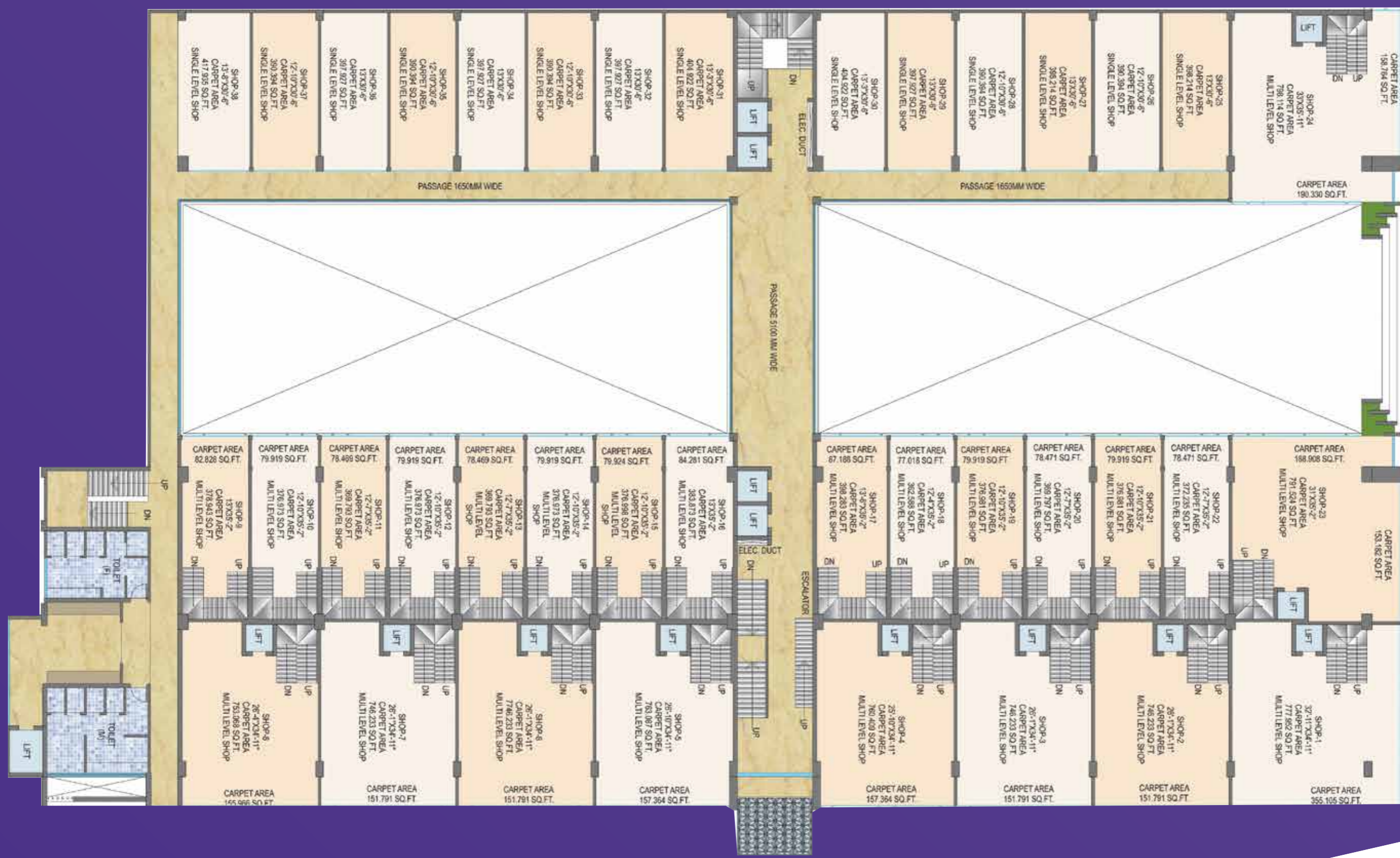

ANANDAM
SHOPPING CENTRE
Anandam World Centre, Nagpur

TYPICAL 3RD FLOOR PLAN





ANANDAM

BUSINESS CENTRE

Anandam World Centre, Nagpur





Artistic Impression

A WORLD WHERE
BUSINESS OUTGROWS



 **ANANDAM**
BUSINESS CENTRE

ENTRANCE LOBBY

Artistic Impression



Artistic Impression



Artistic Impression

DROP OFF AREA

TYPICAL 2ND FLOOR PLAN



TYPICAL 3RD TO 14TH FLOOR PLAN

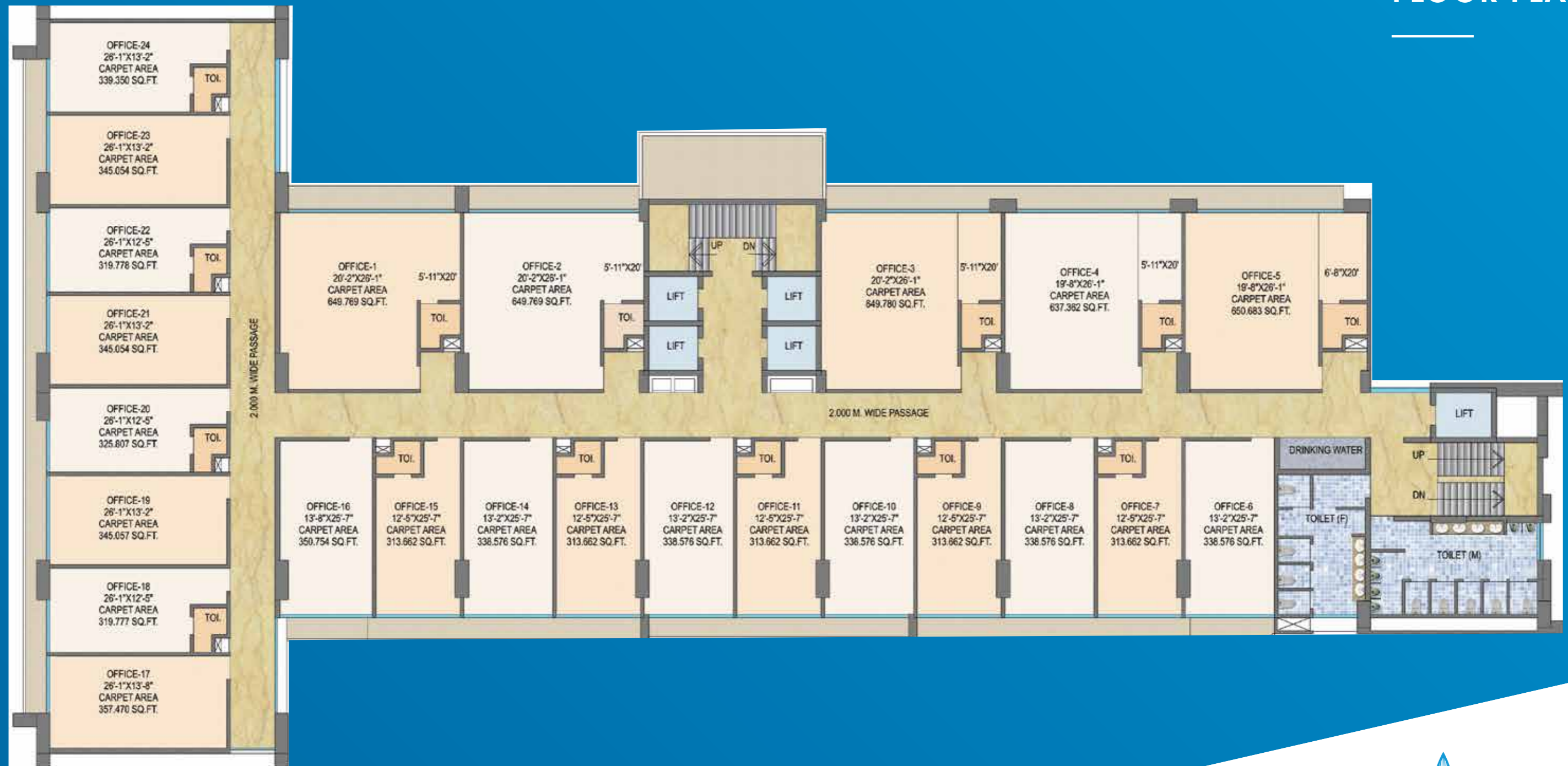



ANANDAM WORLD CENTRE

Anandam World City, Nagpur

Site Office: Anandam World Centre, Anandam World City, Ganeshpeth, Nagpur - 440018

Sales Enquiry: sales.gipl@goldbricks.co.in • Contact Us: +91 97306 34039



To ensure complete transparency, the project has been registered via MahaRERA under Registration Number P50500033711 and is available on the website <https://maharera.mahaonline.gov.in> under registered projects.

Disclaimer: This spiral is purely conceptual and is designed in good faith to give you a fair and overall view of the project and is not a legal offering, nor will it be deemed to be a part of any agreement. Nothing contained in this spiral will take precedence in the final agreement. Number of shops, office spaces, roads, open spaces, parking etc. may be revised. Promoters reserve the right to amend layouts, plans, amenities, areas etc. without notice.